



# Gulf Stream Classic *Hi-Rise* by Gulf Stream Coach

With Hi-Rise Vista View Windows and Outstanding Below-Floor Storage.



## Floorplan Options - Rear

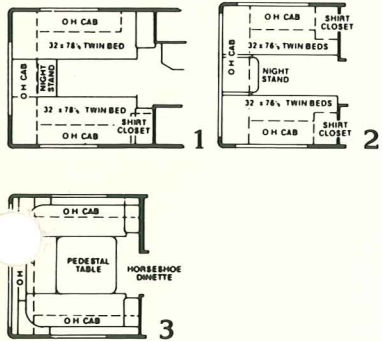

See reverse side for Standard Specifications.

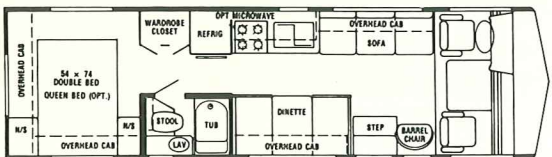

Model 8292-CLHR Rear Opt.:2,3

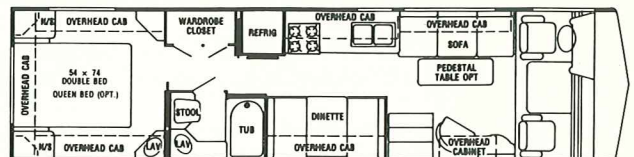

Model 8342-CLHR Rear Opt.:1,3

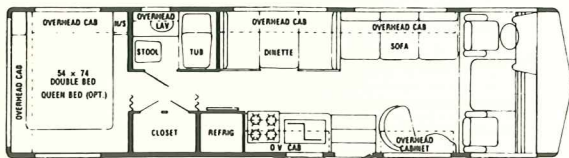

Model 8310-CLHR Rear Opt.:2,3

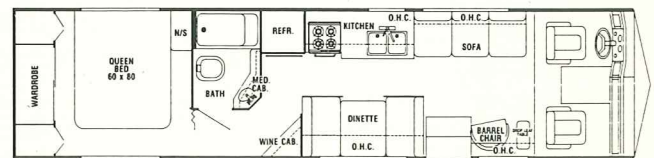

Model 8343-CLHR

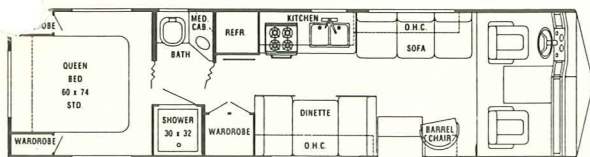

Model 8311-CLHR Rear Opt.:2,3

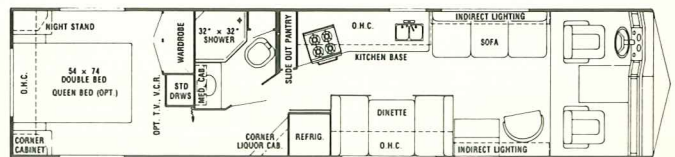

Model 8361-CLHR Rear Opt.:2

# Gulf Stream Classic Hi-Rise

by Gulf Stream Coach

## Standard Specifications

### Interior and Decor

- Solid Raised-Panel Oak Cabinetry
- Natural Wood Paneling
- Wrapped Cabinet Stiles
- Metal Drawer Guides W/Nylon Rollers
- Radius Cabinet & Wall Corners
- Custom Automotive-Style Dash w/Illuminated Gauges
- Windshield Privacy Drape
- Deluxe Furniture
- 3-Way Driver & Passenger Seats
- Deluxe Carpet w/Pad
- Deluxe Door & Window Drapes
- Coordinated Bedspreads & Shams
- Innerspring Mattress
- Mirrored Closet Doors
- Lighted Closets
- Oak-Framed Decorator Mirror
- Decorator Clock & Barometer
- Generous Overhead Storage
- Concealed Storage at Entry

### Exterior and Construction

- Heated & Fully Enclosed Holding Tanks
- Super Structure Steel Truss Type Floor System
- Tubular Steel Cage Construction (16 Gauge, 1½" x 1½")
- Laminated Floors W/Metal Underbelly
- Supplemental Steel Chassis Reinforcement
- Outriggers Welded to Main Frame Rails and Bolted to Floor
- Laminated 2" Thick Floor, Wall and Roof Construction (50% Thicker Than Most Competitors)
- R 7.5 1½" Block Foam Insulation in Floor, Walls and Roof
- Sidewalls Lag-Bolted Every 8" to Floor Structure
- One-Piece Rear Fiberglass Cap
- Fully-Welded Steel Firewall
- Sealed Perimeter and Engine Compartment
- Seamless One-Piece Laminated Aluminum Roof
- Roof Lag-Bolted Every 8" to Sidewalls
- .060" Smooth Fiberglass Siding
- Tinted Windshield & Windows
- Aerodynamic Exterior

- Extraordinary Exterior Storage
- Awning Rail
- Lug Wrench & Jack

### Electrical Systems

- Easy Access Dual Battery System
- 12-Volt, 45-Amp Converter
- Electric Supply Cord
- Electric Overload Protection
- Generator Compartment
- Automotive-Type Color-Coded Wiring
- Pre-Wired for Stereo Speakers
- Lighted Entry Way and Isle Lights
- Directional Reading and Map Lights

### Bath and Water

- Dual Holding Tanks - Approx. 100 Gal
- Fresh Water Tank - Approx. 80 Gal.
- Demand Water System
- City Water Hook-Up
- Double Stainless Steel Sink
- Sink Covers
- Single Lever Faucet in Galley
- Tub/Shower Combination - Most Models
- Marine Toilet (Pedal Flush)
- Mirrored Oak Medicine Cabinet
- Gravity Drains on Fresh Water Lines
- Outside Fresh Water Tank Drain

### Appliances

- 4-Burner Range
- Lighted Power Range Hood
- Large 2-Door, 2-Way Refrigerator
- Microwave Ready

### Heating, Ventilation and Air Conditioning

- 32,000 BTU Ducted Furnace W/Electronic Ignition - Most Models
- Pre-Wired for Roof Air Conditioning

### Deluxe Standard Features

- Driver's Door
- Auto Dash Air Conditioner
- Auto Cruise Control

- Roof Rack & Ladder
- Spare Tire Carrier & Cover
- Wheel Covers
- AM/FM Cassette W/4 Speakers
- Monitor Panel
- Emergency Start Switch
- Power Vent in Commode
- Converter W/Battery Charger
- Auxiliary Battery
- Generator Ready
- 85 Lb. LP Tank

### Chassis

- John Deere Chassis W/460 V-8 Ford Engine
- 454 C.I.D. V-8 Engine
- 3-Speed Automatic Transmission
- Electronic Ignition
- 4.56:1 Rear Axle Ratio
- Power Steering
- High Capacity Automotive Heater
- Stainless Steel Exhaust
- Tilt Steering Wheel
- Wheel Base:
  - Model 8292 - 178"
  - Model 8310 - 178"
  - Model 8311 - 178"
  - Model 8342 - 208"
  - Model 8361 - 228"
- Exterior Length: (Approx.)
  - Model 8292 - 29'
  - Model 8310 - 31'
  - Model 8311 - 31'
  - Model 8342 - 34'
  - Model 8343 - 34'
- Interior Height - 6' 5"
- Coach Body Height - 10' 5"
- Exterior Width 8' 0"
- 4-Wheel Power Disc Brakes - Dual Piston
- Approx. 90 Gal Gas Tank (John Deere Chassis)
- Approx. 60 Gal Gas Tank (GM Chassis)

For further information, contact your local dealer or Gulf Stream Coach, Inc.

Also ask about our other Class A and Class C motorhomes, travel trailers, fifth wheels and custom vans.



P.O. Box 1005 • Nappanee, Indiana 46550

Gulf Stream Coach, Inc. reserves the right to make changes in prices, colors, materials, components and specifications and to discontinue models at any time without notice or obligation. Gulf Stream

Coach, Inc assumes no responsibility for any error in type or print reproduction of specifications or floorplans in this brochure.

**See reverse side for Floorplans**